

**TUERCAS REMACHABLES**

**TUERCAS REMACHABLES  
ACERO / ACERO INOX / ALUMINIO**

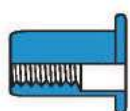

ITT

*Pág.1*

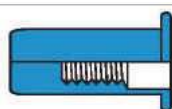

ITTC

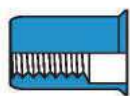

ITR

*Pág.2*

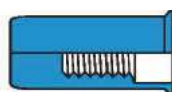

ITRC

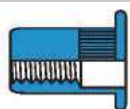

ITTG

*Pág.3*

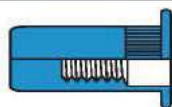

ITTCG

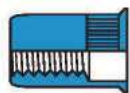

ITRG

*Pág.4*

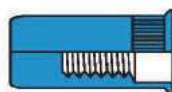

ITRCG

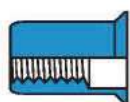

ITS

*Pág.5*

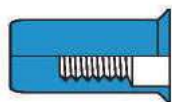

ITS



ITSG

*Pág.6*

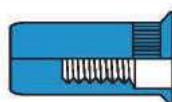

ITSCG

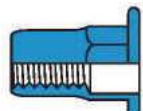

ITTSE

*Pág.7*

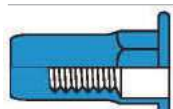

ITTSEC

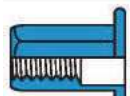

ITTE

*Pág.8*

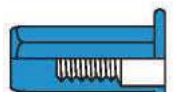

ITTEC

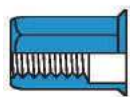

IER

*Pág.9*

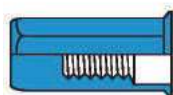

IERC



IERSE

*Pág.10*

## FICHA TÉCNICA

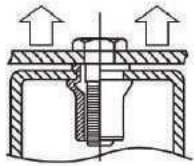

PRUEBA DE CARGA  
EN EL EJE

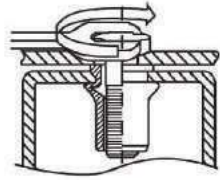

CARGA DE ROTURA

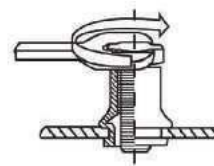

PAR DE APRIETE

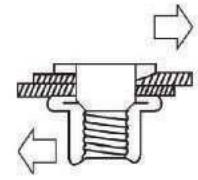

CIZALLADURA  
FUERZA DE ROTURA

### TABLA 1: PRUEBA DE CARGA EN EL EJE PARA ROSCA

Unidad:N

Tuerca remachable	Test mecánico		Medida de la rosca						
			M3	M4	M5	M6	M8	M10	M12
Cilíndrica y Hex.. cabeza plana y (reducida) avellanada	Prueba de carga	acero/inoxidable aluminio	3900	6800	11500	16500	25000	32000	34000
			1900	4000	6500	7800	12300	17500	—

### TABLA 2: CARGA DE ROTURA

Unidad:N.m

Medida de la rosca	M3	M4	M5	M6	M8	M10	M12
Acero/Inox Cabeza plana. cilíndrica y hex	2	3	8.5	15	26	50	80
Acero/Inox Cabeza avellanada. cilíndrica y hex	1	4	8	15	26	45	70
Acero/Inox Cabeza reducida. cilíndrica y hex	1	3	6	11	20	32	50
Alu plana y reducida (avellanada) cabeza cilíndrica	0.7	2.5	5	8	20	25	—

### TABLA 3: PAR DE APRIETE Y FUERZA DE SUJECIÓN

Unidad:N.m

Medida de la rosca	M3	M4	M5	M6	M8	M10	M12
Acero/Inox Cabeza plana. cilíndrica	0.5	1	2	4.5	5.5	11	30
Acero/Inox (Reducida) cabeza avellanada. cilíndrica	0.4	0.8	1.5	3.5	4.5	8.5	24
Aluminio Cabeza plana. cilíndrica	0.25	0.9	1.5	3.5	5	6.5	21
Aluminio (Reducida) avellanada. cilíndrica	0.2	0.7	1.2	2.5	4	5	6

### TABLA 4: CIZALLADURA (FUERZA DE ROTURA)

Unidad:N

Tuerca remachable	Test mecánico		Medida de la rosca						
			M3	M4	M5	M6	M8	M10	M12
Cilíndrica y Hex. Cabeza plana (reducida) avellanada	Cizalla	Acero/Inoxidable Aluminio	900	1500	2000	3000	4400	5000	6500
			600	1000	1200	2000	2400	3800	—

**CILINDRICA CABEZA PLANA**

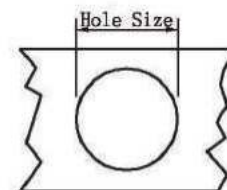
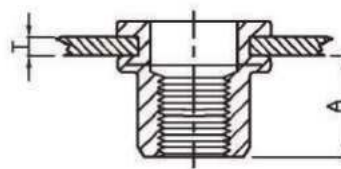
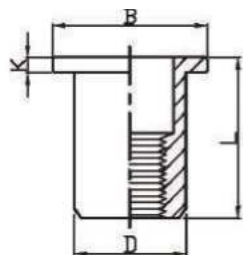

Unidad: mm

Métrica	Referencia	T Min Max	A	Medida agujero +0.1/0	D +0.07 -0.1	B	K	L
M3	BFACITTM03C BFACITTM03L	0.5-1.5	4.7	5.0	4.9	7.2	0.8	8.5
M4	BFACITTM04C BFACITTM04L	1.5-2.5	6.0	6.0	5.9	8.5	0.8	10.5 12.0
M5	BFACITTM05C BFACITTM05L	0.5-2.0 2.0-3.5	7.5 8.5	7.0	6.9	10.0	1.0	13.0 17.0
M6	BFACITTM06C BFACITTM06L	0.5-3.0 3.0-5.5	9.2	9.0	8.9	12.3	1.3	15.5 18.0
M8	BFACITTM08C BFACITTM08L	0.5-3.5 3.5-6.0	11.5	11.0	10.9	15.0	1.5	21.0
M10	BFACITTM10C12 BFACITTM10C13	1.0-3.5 1.0-2.5	11.5 11.5	12.0 13.0	11.9 12.9	16.0 16.3	1.7 1.6	19.5 17.0
M12	BFACITT12C15 BFACITT12C16	0.5-3.5 1.0-4.0	15.5 16.5	15.0 16.0	14.9 15.9	19.0 23.0	1.8 2.0	24.3 26.0

**CILINDRICA CABEZA PLANA CIEGA**

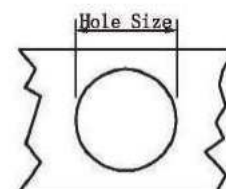
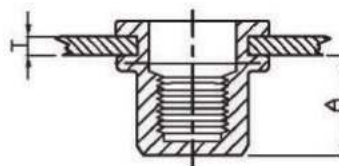
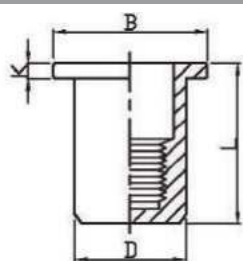

Unidad:mm

Métrica	Referencia	T Min Max	A	Medida agujero +0.1/0	D +0.07 -0.1	B	K	L
M3	BFACITTCM03C	0.5-1.5	10.0	5.0	4.9	7.2	0.8	13.3
M4	BFACITTCM04C BFACITTCM04L	0.5-2.0 2.0-4.0	11.3	6.0	5.9	9.0	0.8	16.0 18.0
M5	BFACITTCM05C BFACITTCM05L	0.5-2.5 2.5-5.0	11.5	7.0	6.9	10.0	1.0	17.0 19.0
M6	BFACITTCM06C BFACITTCM06L	0.5-3.0 3.0-5.5	12.7	9.0	8.9	12.3	1.3	19.2 21.0
M8	BFACITTCM08C BFACITTCM08L	0.5-0.3 3.0-5.5	14.8	11.0	10.9	15.0	1.5	21.5 24.0
M10	BFACITTCM10C	1.0-4.0	19.2	13.0	12.9	17.0	1.6	27.0

**ITR**

**CILINDRICA CABEZA REDUCIDA**

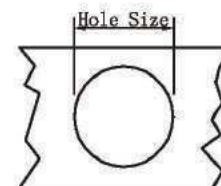
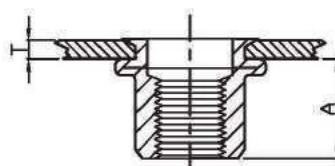
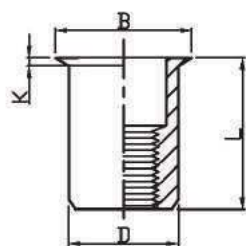

Unidad: mm

Métrica	Referencia	T Min Max	A	Medida agujero +0.1/0	D +0.07 -0.1	B	K	L
M3	BFACITRM03C	0.5-1.5	6.2	5.0	4.9	6.0	0.5	9.0
M4	BFACITRM04C BFACITRM04L	0.5-2.0 2.0-4.0	6.5	6.0	5.9	7.0	0.5	10.5 13.0
M5	BFACITRM05C BFACITRM05L	0.5-2.0 2.0-4.0	7.0	7.0	6.9	8.0	0.5	11.5 13.0
M6	BFACITRM06C BFACITRM06L	0.5-2.5 2.5-5.0	8.5	9.0	8.9	10.5 10.0	0.6 0.6	14.0 17.0
M8	BFACITRM08C BFACITRM08L	0.5-3.0 3.0-5.0	10.0	11.0	10.9	12.0	0.65	16.5 18.5
M10	BFACITR10C12 BFACITR10C13	0.5-3.0 0.5-3.0	12.5 13.0	12.0 13.0	11.9 12.9	13.0 14.1	0.7 0.7	18.0 17.7
M12	BFACITR12C15 BFACITR12C16	0.5-3.5 1.0-4.0	15.5 16.5	15.0 16.0	14.9 15.9	19.0 23.0	1.8 2.0	24.3 26.0

**ITRC**

**CILINDRICA CABEZA REDUCIDA CIEGA**

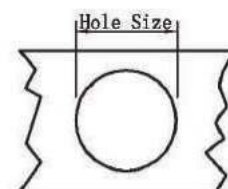
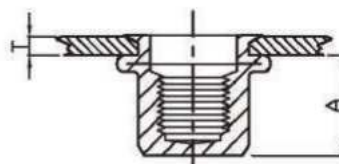
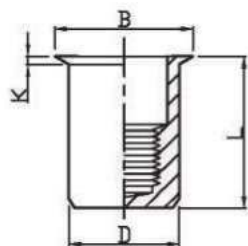

Unidad:mm

Métrica	Referencia	T Min Max	A	Medida agujero +0.1/0	D +0.07 -0.1	B	K	L
M4	BFACITRCM04C BFACITRCM04L	0.5-2.0 2.0-3.5	11.0	6.0	5.9	7.0	0.5	15.0 16.0
M5	BFACITRCM05C BFACITRCM05L	0.5-2.0 2.0-3.5	12.5	7.0	6.9	8.0	0.5	16.5 17.5
M6	BFACITRCM06C BFACITRCM06L	0.5-2.5 2.5-4.0	15.5	9.0	8.9	10.0	0.6	20.5 22.0
M8	BFACITRCM08C BFACITRCM08L	0.5-3.0 2.5-4.5	17.0	11.0	10.9	12.0	0.65	23.0 24.5
M10	BFACITRCM10C BFACITRCM10L	1.0-3.0 3.0-5.0	18.2	13.0	12.9	14.1	0.7	24.5 26.0

**ITTG**

**CILINDRICA RANURADA CABEZA PLANA**

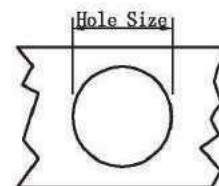
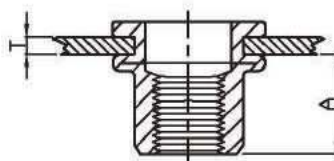
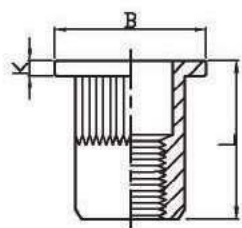

Unidad: mm

Métrica	Referencia	T Min Max	A	Medida agujero +0.1/0	D +0.07 -0.1	B	K	L
M3	BFACITTGM03C	0.5-1.5	6.0	5.0	4.9	8.0	0.8	10.0
	BFACITTGM03L	1.5-3.5	4.5	5.0	4.9	5.5	0.35	11.5
M4	BFACITTGM04C	0.5-2.0	6.0	6.0	5.9	9.0	0.8	10.5
	BFACITTGM04L	2.0-3.5	6.0	6.0	5.9	9.0	0.8	12.0
M5	BFACITTGM05C	0.5-2.5	7.5	7.0	6.9	10.0	1.0	13.0
	BFACITTGM05L	2.5-5.0	8.5	7.0	6.9	10.0	1.0	16.5
M6	BFACITTGM06C	0.5-3.0	9.2	9.0	8.9	12.30 *(13.0)	1.3	15.5
	BFACITTGM06L	3.0-5.5	10.5	9.0	8.9	12.30 *(13.0)	1.3	19.5
M8	BFACITTGM08C	1.0-3.5	11.5	11.0	10.9	14.5(*16.0)	1.5	18.5
	BFACITTGM08L	3.5-6.0	11.5	11.0	10.9	14.5(*16.0)	1.5	21.0
M10	BFACITTG10C12	0.5-3.5	12.5	12.0	11.9	16.0	1.8	12.5
	BFACITTG10L12	2.5-6.5	12.5	12.0	11.9	16.0	1.8	12.5
M10	BFACITTG10C13	1.0-4.0	13.5	13.0	12.9	17.0	1.7	13.5
	BFACITTG10L13	2.5-6.5	12.5	13.0	12.9	17.0	1.8	12.5
M12	BFACITRM12C15	0.5-3.5	15.5	15.0	14.9	19.0	1.8	15.5
M12	BFACITTG12C16	1.0-4.0	16.5	16.0	15.9	23.0	2.0	16.5
	BFACITTG12L16	3.5-7.0	16.5	16.0	15.9	23.0	2.0	16.5

**ITTCG**

**CILINDRICA RANURADA CABEZA PLANA CIEGA**

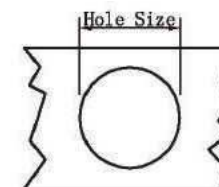
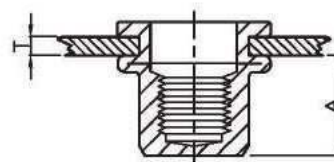
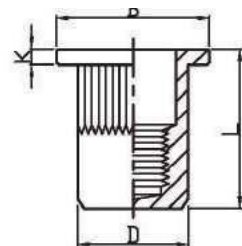

Unidad:mm

Métrica	Referencia	T Min Max	A	Medida agujero +0.1/0	D +0.07 -0.1	B	K	L
M4	BFACITTCGM04C	0.5-2.0	11.3	6.0	5.9	9.0	0.8	16.0
	BFACITTCGM04L	2.0-4.0	11.3	6.0	5.9	9.0	0.8	18.0
M5	BFACITTCGM05C	0.5-3.0	11.5	7.0	6.9	10.0	1.0	17.0
	BFACITTCGM05L	2.5-5.0	11.5	7.0	6.9	10.0	1.0	19.0
M6	BFACITTCGM06C	0.5-3.0	12.7	9.0	8.9	12.3	1.3	19.2
	BFACITTCGM06L	3.0-5.0	12.7	9.0	8.9	12.3	1.3	21.0
M8	BFACITTCGM08C	0.5-3.0	14.8	11.0	10.9	15.0	1.5	21.5
	BFACITTCGM08L	3.0-5.5	14.8	11.0	10.9	15.0	1.5	24.0
M10	BFACITTCG10C13	0.5-3.5	26.5	13.0	12.9	17.0	1.8	34.3

**ITRG**

**CILINDRICA RANURADA CABEZA REDUCIDA**

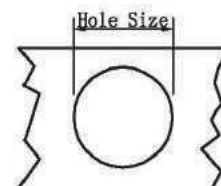
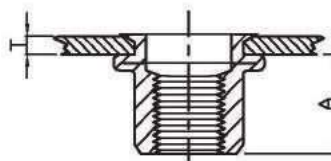
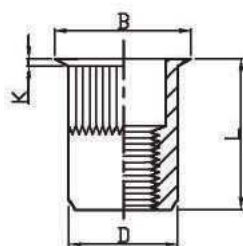

Unidad: mm

Métrica	Referencia	T Min Max	A	Medida agujero +0.1/0	D +0.07 -0.1	B	K	L
M3	BFACITRGM03C	0.5-2.0	6.2	5.0	4.9	6.0	0.5	9.0
	BFACITRGM03L	1.5-3.5	5.5	5.0	4.9	5.5	0.35	11.5
M4	BFACITRGM04C	0.5-2.0	7.0	6.0	5.9	7.0	0.5	11.2
	BFACITRGM04L	2.0-4.0	7.0	6.0	5.9	7.0	0.5	13.0
M5	BFACITRGM05C	0.5-2.0	7.0	7.0	6.9	8.0	0.5	11.5
	BFACITRGM05L	2.0-4.0	7.0	7.0	6.9	8.0	0.5	13.0
M6	BFACITRGM06C	0.5-2.5	8.5	9.0	8.9	10.0	0.6	14.0
	BFACITRGM06L	2.5-5.0	8.5	9.0	8.9	10.0	0.6	16.0
M8	BFACITRGM08C	0.5-3.0	10.0	11.0	10.9	12.0	0.65	16.5
	BFACITRGM08L	3.0-5.0	10.0	11.0	10.9	12.0	0.65	18.5
M10	BFACITRGM10C12	0.5-3.5	13.0	12.0	11.9	13.5	0.85	19.0
	BFACITRGM10L12	2.5-6.5	12.5	12.0	11.9	13.3	0.85	24.0
M10	BFACITRGM10C13	0.5-3.5	13.0	13.0	12.9	14.5	0.85	19.0
	BFACITRGM10L13	2.5-6.5	12.5	13.0	12.9	14.3	0.85	24.0
M12	BFACITRGM12C15	0.5-3.5	16.0	15.0	14.9	16.5	0.85	22.5
M12	BFACITRGM12C16	1.0-4.0	16.0	16.0	15.9	17.2	0.6	24.0
	BFACITRGM12L16	3.5-7.5	16.0	16.0	15.9	17.2	0.6	27.5

**ITRCG**

**CILINDRICA RANURADA CABEZA REDUCIDA CIEGA**

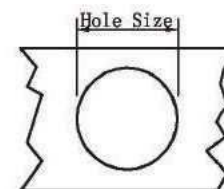
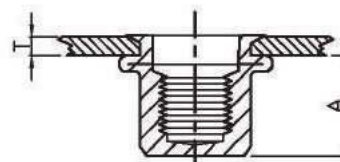
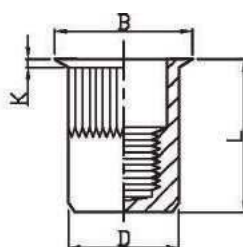

Unidad:mm

Métrica	Referencia	T Min Max	A	Medida agujero +0.1/0	D +0.07 -0.1	B	K	L
M4	BFACITRCGM04C	0.5-2.0	11.0	6.0	5.9	7.0	0.5	15.0
	BFACITRCGM04L	2.0-3.5	11.0	6.0	5.9	7.0	0.5	16.5
M5	BFACITRCGM05C	0.5-2.0	12.5	7.0	6.9	8.0	0.5	16.5
	BFACITRCGM05L	2.0-3.5	12.5	7.0	6.9	8.0	0.5	18.0
M6	BFACITRCGM06C	0.5-3.0	15.5	9.0	8.9	10.0	0.6	20.5
	BFACITRCGM06L	3.0-4.5	15.5	9.0	8.9	10.0	0.6	22.0
M8	BFACITRCGM08C	0.5-3.0	17.0	11.0	10.9	12.0	0.65	23.0
	BFACITRCGM08L	3.0-4.5	17.0	11.0	10.9	12.0	0.65	24.5
M10	BFACITRCG10C13	0.5-3.5	20.7	13.0	12.9	14.5	0.85	33.0

**ITS**

**CILINDRICA CABEZA AVELLANADA**

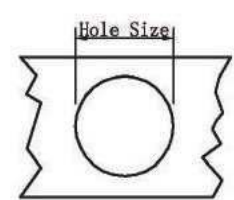
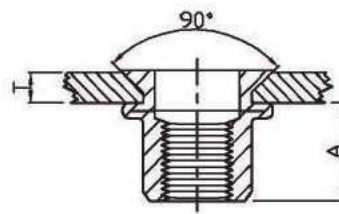
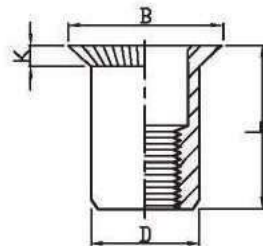

Unidad: mm

Métrica	Referencia	T Min Max	A	Medida agujero +0.1/0	D +0.07 -0.1	B	K	L
M3	BFACITSM03C	0.5-3.0	6.5	6.0	5.9	9.0	1.5	12.0
M4	BFACITSM04C	1.5-3.5	7.5	7.0	6.9	10.0	1.5	13.0
M5	BFACITSM05C	1.5-4.0	9.0	9.0	8.9	12.0	1.5	15.5
M6	BFACITSM06C	2.0-4.5	11.0	11.0	10.9	14.0	1.5	18.5
M8	BFACITSM08C	2.0-5.0	13.0	13.0	12.9	16.0	1.5	21.0
M10	BFACITSM10C12	1.6-5.0	11.5	12.0	11.9	15.0	1.5	19.0
M10	BFACITSM10C13	1.6-5.0	11.5	13.0	12.9	16.0	1.5	19.0
M12	BFACITSM12C15	1.6-5.0	14.5	15.0	14.9	18.0	1.5	22.5
M12	BFACITSM12C16	1.7-4.5	17.5	16.0	15.9	19.0	1.9	26.0



**ITSG**

**CILINDRICA RANURADA CABEZA REDUCIDA**

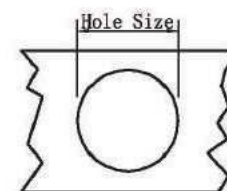
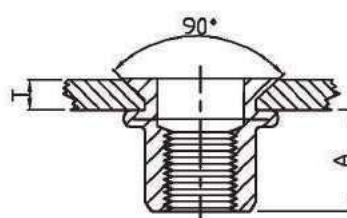
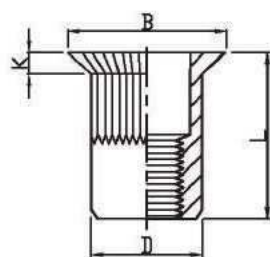

Unidad: mm

Métrica	Referencia	T Min Max	A	Medida agujero +0.1/0	D +0.07 -0.1	B	K	L
M3	BFACITSGM03C							
M4	BFACITSGM04C BFACITSGM04L	1.5-3.0	6.5	6.0	5.9	9.0	1.5	12.0
M5	BFACITSGM05C BFACITSGM05L	1.5-3.5	7.5	7.0	6.9	10.0	1.5	13.0
M6	BFACITSGM06C BFACITSGM06L	1.5-4.0	9.0	9.0	8.9	12.0	1.5	15.5
M8	BFACITSGM08C BFACITSGM08L	2.0-4.5	11.0	11.0	10.9	14.0	1.5	18.5
M10	BFACITSGM10C12	1.6-5.0	11.5	12.0	11.9	15.0	1.5	19.0
M10	BFACITSGM10C13	1.6-5.0	11.5	13.0	12.9	16.0	1.5	19.0
M12	BFACITSGM12C15	1.6-5.0	14.5	15.0	14.9	18.0	1.5	22.5
M12	BFACITSGM12C16	1.7-4.5	17.5	16.0	15.9	19.0	1.9	26.0

**ITSCG**

**CILINDRICA RANURADA CABEZA AVELLANADA CIEGA**

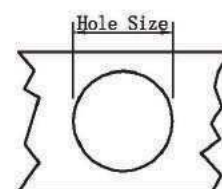
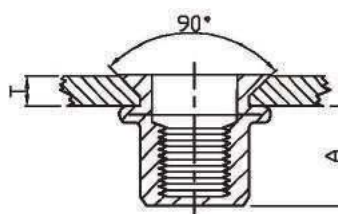
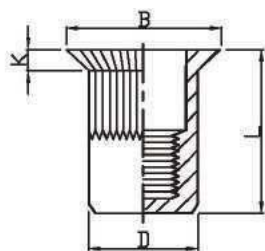

Unidad: mm

Métrica	Referencia	T Min Max	A	Medida agujero +0.1/0	D +0.07 -0.1	B	K	L
M4	BFACITSCGM04C	1.5-3.0	10.5	6.0	5.9	8.5	1.5	17.5
M5	BFACITSCGM05C	1.5-3.5	11.5	7.0	6.9	9.5	1.5	20.0
M6	BFACITSCGM06C	1.5-4.0	12.7	9.0	8.9	11.5	1.5	23.0
M8	BFACITSCGM08C	1.5-4.0	14.0	11.0	10.9	13.5	1.5	27.0
M10	BFACITSCG10C13	1.6-5.0	21.5	13.0	12.9	16.0	1.5	33.0



**ITTSE**

**SEMI-HEXAGONAL CABEZA PLANA**

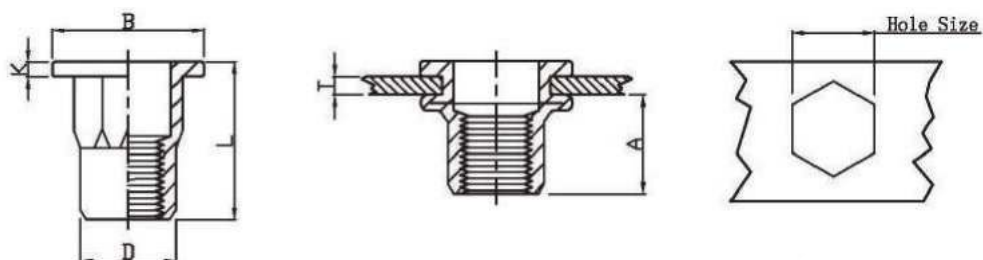

Unidad: mm

Métrica	Referencia	T Min Max	A	Medida agujero +0.1/0	D +0.07 -0.1	B	K	L
M3	BFACITTSEM03C	0.3-1.8	5.5	5.0	4.9	8.0	0.75	9.0
	BFACITTSEM03L	1.8-3.0	5.5	5.0	4.9	8.0	0.75	10.0
M4	BFACITTSEM04C	0.5-2.0	6.5	6.0	5.9	9.0	0.8	11.0
	BFACITTSEM04L	2.5-4.0	6.0	6.0	5.9	9.0	0.75	12.5
M5	BFACITTSEM05C	0.5-2.5	8.0	7.0	6.9	10.0	1.0	13.0
	BFACITTSEM05L	2.0-4.0	8.0	7.0	6.9	10.0	1.0	15.0
M6	BFACITTSEM06C	0.5-3.0	8.5	9.0	8.9	12.7	1.35	15.0
	BFACITTSEM06L	3.5-6.0	9.0	9.0	8.9	13.0	1.5	19.0
M8	BFACITTSEM08C	1.0-3.5	10.5	11.0	10.9	16.0	1.5	18.0
	BFACITTSEM08L	3.0-6.0	10.0	11.0	10.9	16.0	1.5	20.0
M10	BFACITTSEM10C12	0.8-3.5	10.5	12.0	11.9	16.0	1.7	19.0
	BFACITTSEM10L12	3.5-6.0	10.5	12.0	11.9	16.0	1.7	22.0
M10	BFACITTSEM10C13	1.0-4.0	14.5	13.0	12.9	16.3	2.0	24.0
	BFACITTSEM10L13	3.0-6.0	14.5	13.0	12.9	19.0	2.0	26.0
M12	BFACITTSEM12C16	2.0-5.0	16.5	16.0	15.9	23.0	2.2	27.5

**ITTSEC**

**SEMI-HEXAGONAL CABEZA PLANA CIEGA**

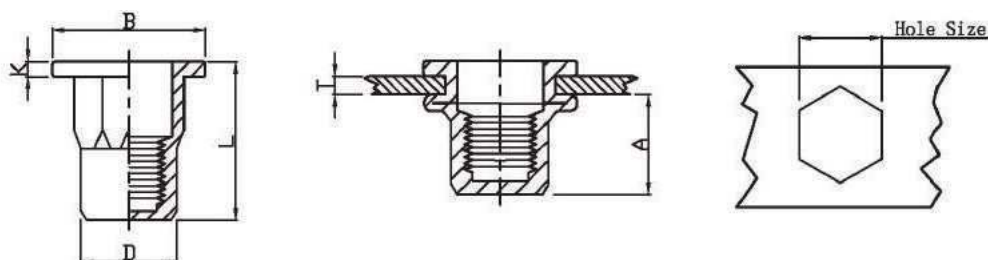

Unidad: mm

Métrica	Referencia	T Min Max	A	Medida agujero +0.1/0	D +0.07 -0.1	B	K	L
M4	BFACITTSECM04C	0.5-2.0	11.0	6.0	5.9	9.0	0.8	15.0
M5	BFACITTSECM05C	0.5-2.5	13.5	7.0	6.9	10.0	1.0	18.0
M6	BFACITTSECM06C	0.5-3.0	17.0	9.0	8.9	12.7	1.3	23.0
M8	BFACITTSECM08C	1.0-3.5	19.0	11.0	10.9	16.0	1.5	26.0
M10	BFACITTSECM10C13	1.0-4.0	25.0	13.0	12.9	19.0	1.7	33.0

**ITTE**

ACERO ZINCADO CROMO III

**HEXAGONAL CABEZA PLANA**

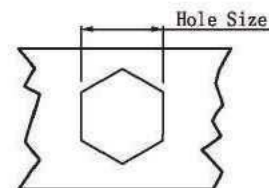
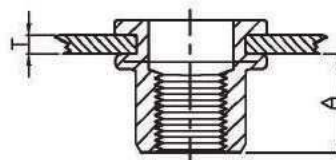
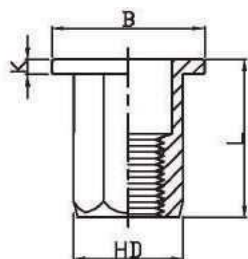

Unidad: mm

Métrica	Referencia	T Min Max	A	Medida agujero +0.1/0	D +0.07 -0.1	B	K	L
M4	BFACITTEM04C	0.5-2.0	6.5	6.0	5.9	9.0	0.8	11.0
	BFACITTEM04L	2.0-4.0	6.5	6.0	5.9	9.0	0.8	13.5
M5	BFACITTEM05C	0.5-2.5	8.0	7.0	6.9	10.0	1.0	14.0
	BFACITTEM05L	2.0-5.0	8.0	7.0	6.9	10.0	1.0	16.5
M6	BFACITTEM06C	0.5-3.0	8.5	9.0	8.9	12.7-13.0	1.35	15.0-16.0
	BFACITTEM06L	3.0-6.0	8.5	9.0	8.9	13.0	1.5	19.5
M8	BFACITTEM08C	1.0-3.5	8.5	11.0	10.9	16.0	1.5	18.0
	BFACITTEM08L	3.0-6.0	8.5	11.0	10.9	15.0	1.5	21.5
M10	BFACITTEM10C12	0.5-3.5	12.0	12.0	11.9	17.0	1.8	20.3
M10	BFACITTEM10C13	0.5-3.5	12.0	13.0	12.9	17.0	1.8	20.3
	BFACITTEM10L13	3.0-6.0	11.5	13.0	12.9	17.0	1.5	24.0
M12	BFACITTEM12C15	1.0-3.5	16.0	15.0	14.9	19.0	1.8	24.3
M12	BFACITTEM12C16	1.0-4.0	16.5	16.0	15.9	23.0	2.0	27.0

**ITTEC**

**HEXAGONAL CABEZA PLANA CIEGA**

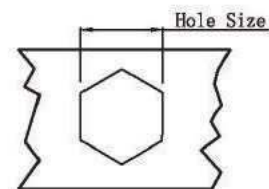
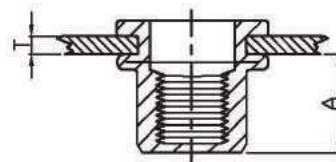
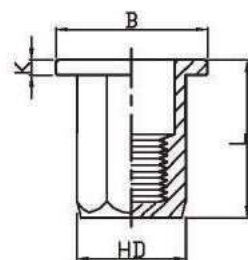

Unidad:mm

Métrica	Referencia	T Min Max	A	Medida agujero +0.1/0	D +0.07 -0.1	B	K	L
M4	BFACITTECM04C	0.5-2.0	11.0	6.0	5.9	9.0	0.8	15.0
M5	BFACITTECM05C	0.5-2.5	13.5	7.0	6.9	10.0	1.0	18.0
M6	BFACITTECM06C	0.5-3.0	17.0	9.0	8.9	12.7	1.5	23.0
M8	BFACITTECM08C	1.0-3.5	19.0	11.0	10.9	16.0	1.5	26.0
M10	BFACITTECM10C13	1.0-4.0	25.0	13.0	12.9	19.0	2.0	33.0

**IER**

ACERO ZINCADO CROMO III

**HEXAGONAL CABEZA REDUCIDA**

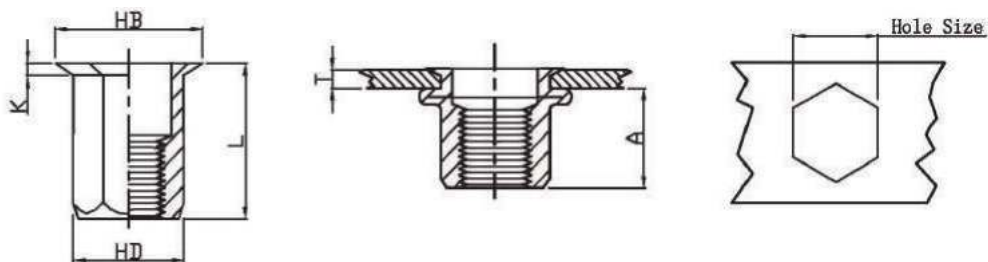

Unidad: mm

Métrica	Referencia	T Min Max	A	Medida agujero +0.1/0	D +0.07 -0.1	B	K	L
M4	BFACIERM04C BFACIERM04L	0.5-2.5 2.5-5.0	6.7	6.0	5.9	7.0	0.5	11.0 13.5
M5	BFACIERM05C BFACIERM05L	0.5-3.0 3.0-5.0	9.0	7.0	6.9	8.0	0.5	14.5 16.0
M6	BFACIERM06C BFACIERM06L	1.0-3.5 3.5-6.0	10.0	9.0	8.9	10.0	0.6	16.0 18.0
M8	BFACIERM08C BFACIERM08L	1.0-4.0 4.0-6.0	11.5	11.0	10.9	12.0	0.65	18.0 20.0
M10	BFACIERM10C12	1.0-3.5 3.5-6.0	12.5 14.5	13.0	12.9	14.5	0.75	19.0 23.5
M10	BFACIERM10C13 BFACIERM10L13	1.0-4.0	15.5	16.0	15.9	17.5	1.0	25.0
M12	BFACIERM12C15	1.0-3.5	16.0	15.0	14.9	19.0	1.8	24.3
M12	BFACIERM12C16	1.0-4.0	15.5	16.0	15.9	17.5	1.0	25.0

**IERC**

**HEXAGONAL CABEZA REDUCIDA CIEGA**

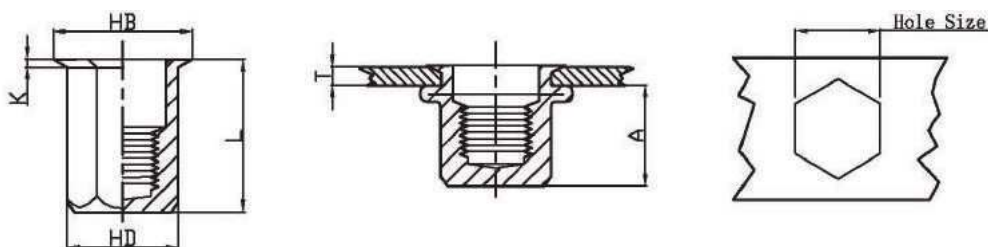

Unidad:mm

Métrica	Referencia	T Min Max	A	Medida agujero +0.1/0	D +0.07 -0.1	B	K	L
M4	BFACIERCM04C	0.5-2.5	12.3	6.0	5.9	7.0	0.5	16.0
M5	BFACIERCM05C	0.5-3.0	15.2	7.0	6.9	8.0	0.5	20.0
M6	BFACIERCM06C	0.5-3.5	14.5	9.0	8.9	10.0	0.6	20.5
M8	BFACIERCM08C	1.0-4.0	17.0	11.0	10.9	12.0	0.65	23.0
M10	BFACIERCM10C13	1.0-4.5	20.0	13.0	12.9	14.5	0.75	28.5

**SEMI-HEXAGONAL CABEZA REDUCIDA**

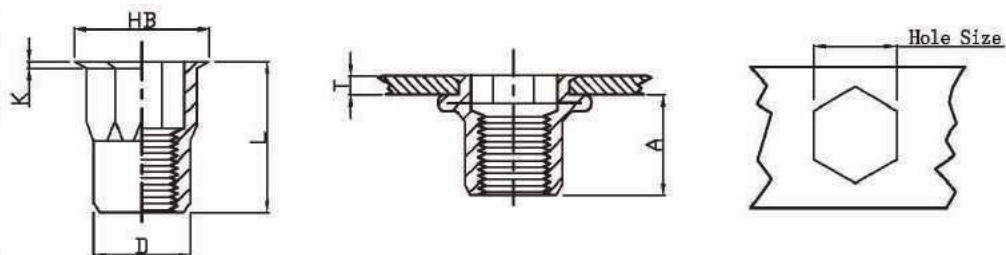

Unidad: mm

Métrica	Referencia	T Min Max	A	Medida agujero +0.1/0	D +0.07 -0.1	B	K	L
M3	BFACIERSEM03C BFACIERSEM03L	0.3-1.5 1.5-2.5	5.5 5.5	5.0 5.0	4.9 4.9	5.6 5.6	0.35 0.35	8.5 10.0
M4	BFACIERSEM04C BFACIERSEM04L	0.5-2.5 2.5-4.0	6.0 6.0	6.0 6.0	5.9 5.9	6.5 7.0	0.6 0.5	12.0 12.5
M5	BFACIERSEM05C BFACIERSEM05L	0.5-3.0 2.5-4.5	7.0 6.8	7.0 7.0	6.9 6.9	7.5 8.0	0.6 0.5	14.0 13.0
M6	BFACIERSEM06C BFACIERSEM06L	0.5-3.0 3.5-6.0	8.6 8.6	9.0 9.0	8.9 8.9	9.5 10.0	0.6 0.5	16.0 17.5
M8	BFACIERSEM08C BFACITTSEM08L	0.5-3.0 3.0-6.0	10.0 10.0	11.0 11.0	10.9 10.9	11.5 12.0	0.6 0.5	17.0 19.5
M10	BFACIERSEM10C12 BFACIERSEM10L12	0.8-3.0 2.0-4.5	11.2 11.2	12.0 12.0	11.9 11.9	13.5 13.5	0.8 0.8	19.0 18.0
M10	BFACIERSEM10C13 BFACIERSEM10L13	1.0-4.0 3.0-6.0	13.0 13.3	13.0 13.0	12.9 12.9	13.5 14.0	0.6 0.5	19.5 20.5
M12	BFACIERSEM12C16	1.0-4.0	14.8	16.0	15.9	17.5	1.0	23.0